

Kv. Lindgården  
Tägmästaren

Stg. nr 148, 149, 158, 162, 164, 169

650

Karta  
öfver  
Tomtplatser  
afskräade  
Per Mattsgården N<sup>o</sup> 116 & 118 samt Lindgården N<sup>o</sup> 119  
upprättad år 1913  
af  
Carl Olander  
Stadsingeniör

Bestyrelse:

af Lindgården N <sup>o</sup> 119 - f. a.	för lomt 3 Kv Saturnus ref.	= 58,50
" " " " " b.	" Stationsgatan "	= 407,70
" " " " " c.	" lomt 5 & 6 Kv Uranus "	= 13,50
" " " " " 1.	" " " "	= 495,35
" " " " " 2.	" " " "	= 29,20
Per Mattsgården N <sup>o</sup> 116	d. 1. " " "	= 580,70
" " " " " 2.	" " " "	= 782,28
" " " " " e.	Bangårdsgatan	= 966,86
" " " " " f.	Stationsgatan	= 58,40
" " " " " g.	" " " "	= 93,67
" " " " " h.	" " " "	= 276,49
" " " " " i.	" " " "	= 157,50
" " " " " j.	" " " "	= 755,30
" " " " " k.	" " " "	= 41,82
" " " " " l.	" " " "	= 103,12
" " " " " m.	" " " "	= 131,65

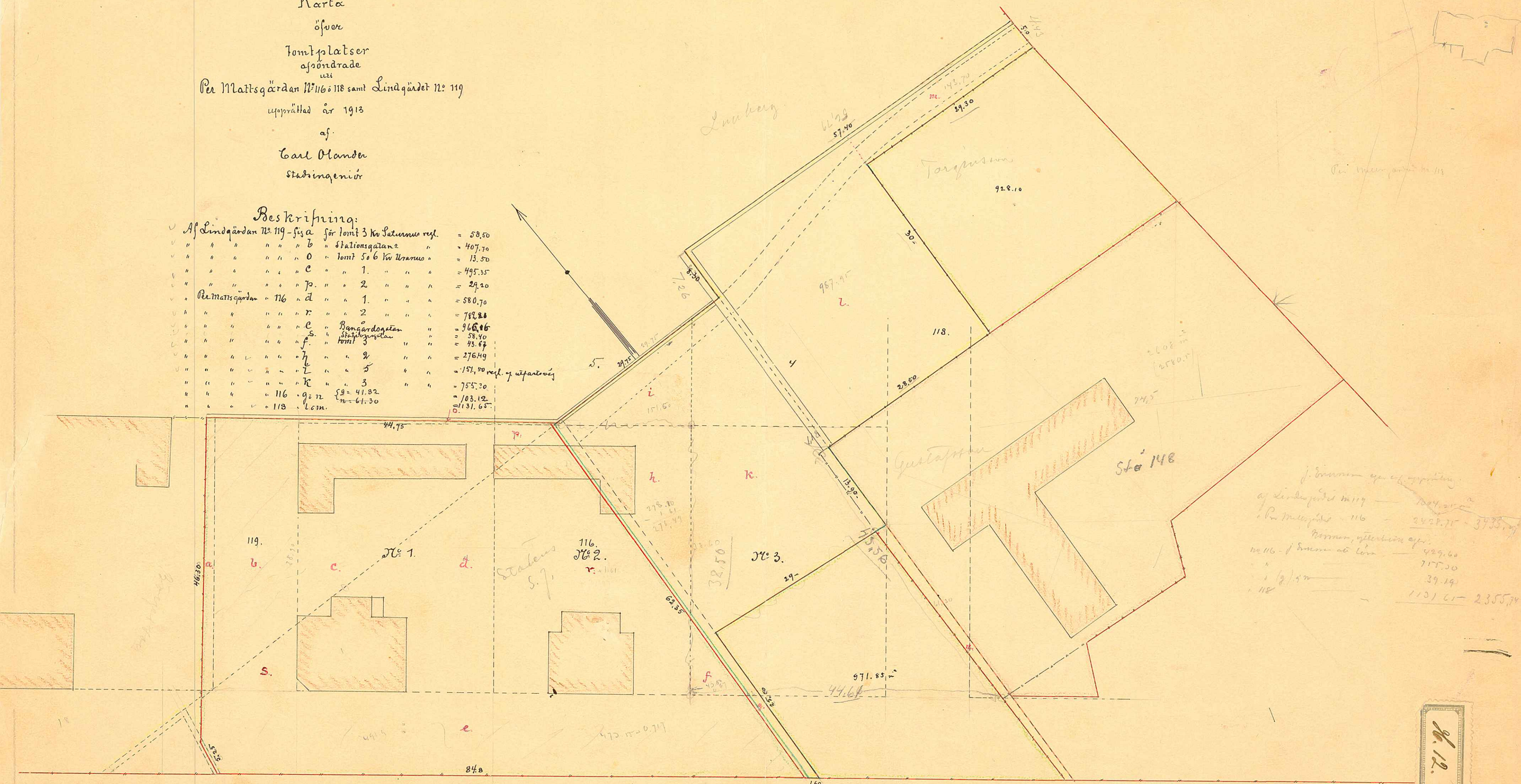

J. Österman upprättad af  
af Lindgården N<sup>o</sup> 119 — 1004,20 m<sup>2</sup>  
Per Mattsgården N<sup>o</sup> 116 — 2428,75 - 3735,00 m<sup>2</sup>  
Per Mattsgården N<sup>o</sup> 118 — 429,60 m<sup>2</sup>  
" " " " " 119 — 715,30 m<sup>2</sup>  
" " " " " 120 — 39,19 m<sup>2</sup>  
" " " " " 121 — 1131,65 - 2355,74 m<sup>2</sup>

3863,42  
427,99  
5435,44

427,99

276,49  
782,28  
99,20  
877,90

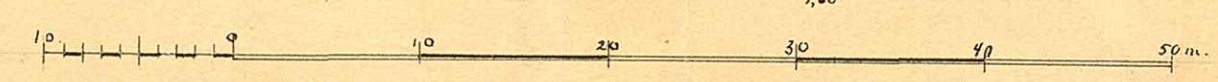

A STADS BYGGNADSKO  
A 17:18 / 19 (LIT. K. Nr 822)

1913