

186

168-169.

KARTA

öfver
 Tomten N^o 3^a och 3^b
 uti
 Quarteret Vale
 af
 Umeå Stad
 upprättad år 1903 af
Carl Oland
 T.f. Stadsingeniören

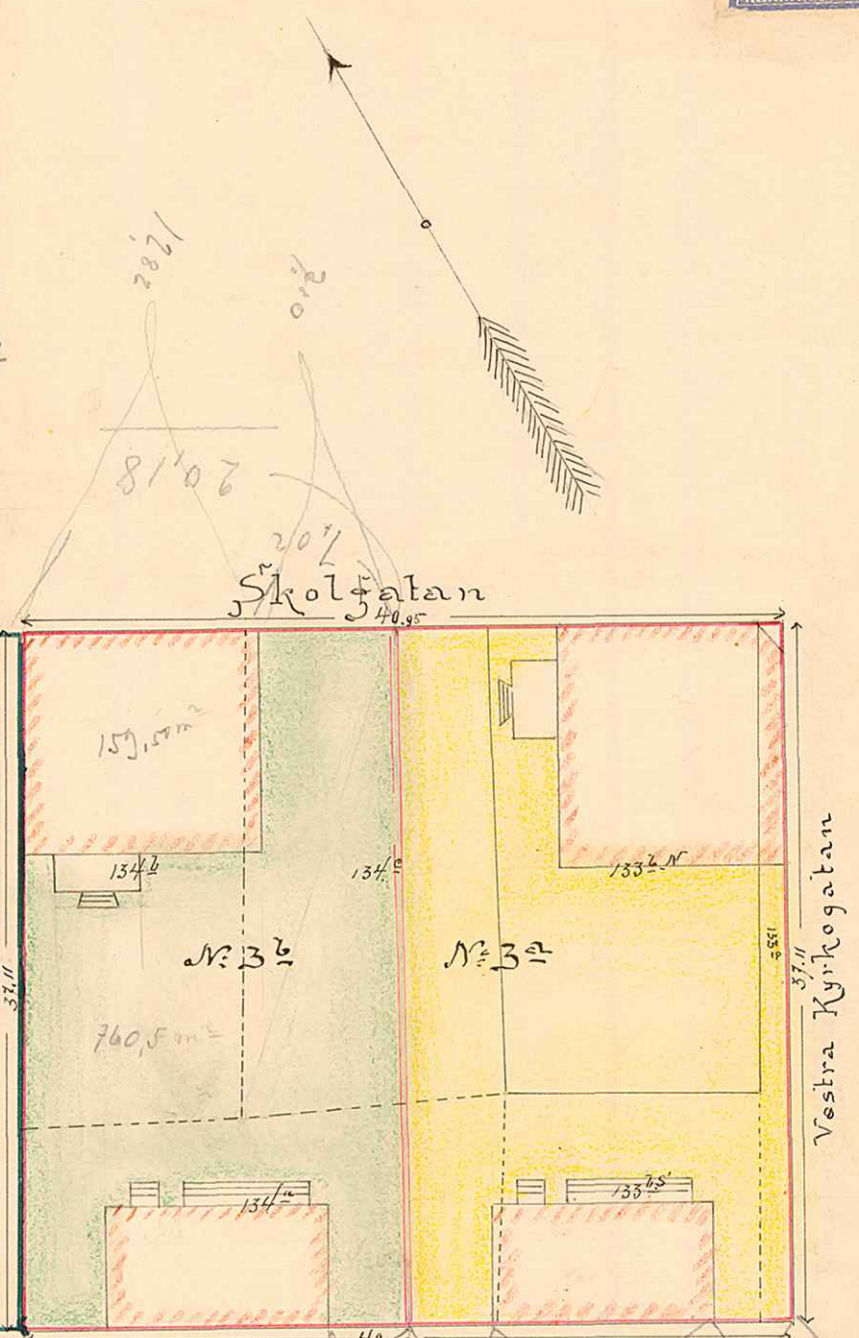

12,85
 7,07
 19,92 + 0,26 = Gr. mur röstad
 20,18

N^o 4

Beskrifning:

Tomten utföres af följande äldre tomtdelar:

Af N ^o 133 ^a	Handlanden C.J. Anderson	356,0 qv.m.
" " 133 ^a	Umeå Stad	40,0 " " "
" " 133 ^b	" " "	172,0 " " "
" " 134 ^a	" " "	292,0 " " "
" " 134 ^b	" " "	310,0 " " "
" " 134 ^c	" " "	351,0 " " "
		<u>1521,0 qv.m. (1519,65)</u>

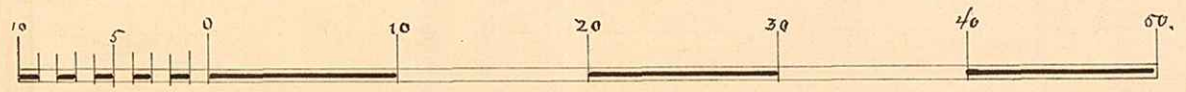

UMEA STADS BYGGNADSKONTOR,
 Ritad av
 Den ... / ... 19... Likt N^o 418

9,03

1/12